

# Series HSCS

## Horizontal Split Case Pumps

Replacement Parts



# Index

<b>Description</b>	<b>Page No.</b>
Exploded View .....	3
Parts List for 6x10x22, 8x12x22M, 8x12x22L, 8x12x27, and 10x14x20S.....	4
Parts List for 10x14x20L, 12x16x23, 14x16x17, 14x18x23, and 14x18x28 .....	5

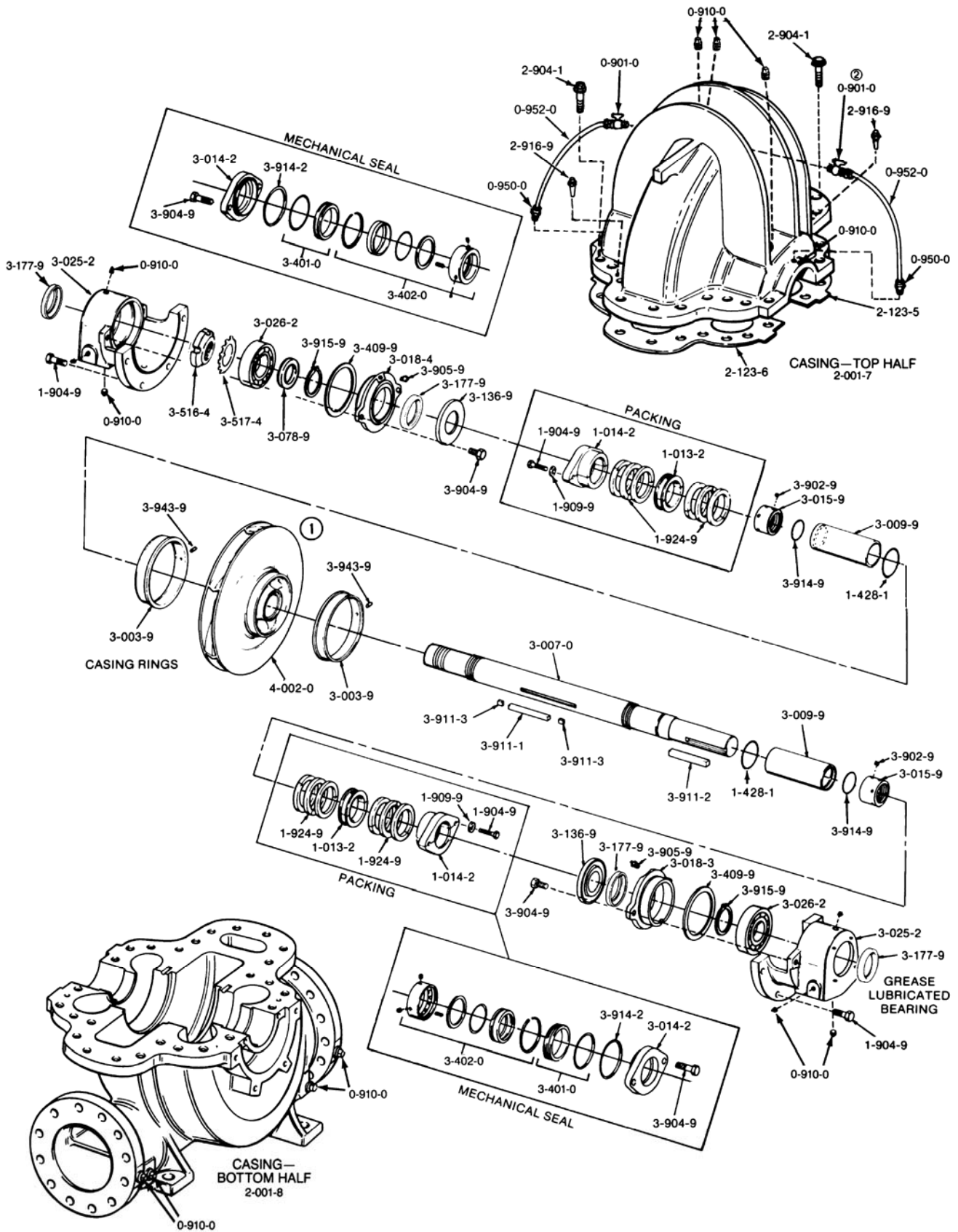

Impeller Assembly 0-002-0 Includes Impeller and Impeller Wearing Rings.

0-901-0 Valves Are Optional for Packed Pumps and Not Furnished on Mechanical Seal Pumps.

ITEM NO.	PART DESCRIPTION	QTY.	MATERIAL	6x10x22	8x12x22M	8x12x22L	8x12x27	10x14x20S
2-001-0	Casing Assembly	1	Cast Iron	08-112-782-501	08-112-783-501	→	N/A	08-111-626-501
2-001-0	Casing Assembly	1	Ductile Iron	08-112-782-520	08-112-783-520	→	52-122-206-520	08-111-626-520
4-002-0	Impeller w/o Rings	1	Silicon Brass	08-217-811-002	52-231-707-002	08-217-812-103	52-229-973-002	08-217-813-002
4-002-0	Impeller w/ Rings	1	Silicon Brass	52-229-465-502	52-231-709-502	52-229-488-558	52-241-271-502	52-229-512-502
3-003-9	Casing Wear Ring	2	Bronze	08-111-670-001	08-111-671-001	→	52-122-020-004	08-111-672-001
0-004-0	Impeller Wear Ring	2	Bronze	52-120-525-001	52-120-557-009	→	52-122-022-001	52-120-560-001
2-123-6	Gasket, Discharge (CI Casing)	1	Vellumoid	08-217-564-005	08-217-566-005	→	N/A	08-217-568-005
2-123-6	Gasket, Discharge (DI Casing)	1	Vellumoid	08-217-564-005	52-327-410-005	→	52-232-533-005	52-237-035-005
2-123-5	Gasket, Suction (CI Casing)	1	Vellumoid	08-217-563-005	08-217-565-005	→	N/A	08-217-567-005
2-123-5	Gasket, Suction (DI Casing)	1	Vellumoid	08-217-563-005	52-327-409-005	→	52-232-532-005	52-237-034-005
3-007-0	Shaft	1	Steel	52-329-573-001	→	→	52-329-572-004**	52-329-573-001
3-007-0	Shaft	1	316 Stn. Stl.	52-329-573-002	→	→	52-329-572-004**	52-329-573-002
3-009-9	Shaft Sleeve (1)	2	Bronze	52-239-611-001	→	→	52-239-612-001	→
3-009-9	Shaft Sleeve (2)	2	Bronze	52-239-614-001	→	→	52-239-615-001	→
1-428-1	Gasket, Sleeve	2	Synthetic (Non-Asbestos)	70782-202B-5180	→	→	→	→
3-015-9	Nut, Shaft Sleeve (1)	2	Bronze	52-128-684-001	→	→	→	→
3-015-9	Nut, Shaft Sleeve (2)	2	Bronze	52-128-684-001	→	→	→	→
3-902-9	Set Screw, Sleeve Nut	2	316 Stn. Stl.	49514-204	→	→	→	→
3-911-1	Impeller Key	1	316 Stn. Stl.	49568-328	→	→	→	→
3-911-2	Key, Coupling	1	Steel	49568-459	→	→	→	→
3-911-3	Key, Sleeve	2	316 Stn. Stl.	52-119-854-005	→	→	→	→
3-914-9	O-Ring, Shaft Sleeve	2	Buna-N	C02495A152-5302	→	→	→	→
3-943-9	Anti-Rotation Pin	2	302 Stn. Stl.	CP-671-181-371	→	→	→	→
0-910-0	Pipe Plug, 1/4"	15	Steel	AC0532	→	→	→	→
0-910-0	Pipe Plug, 1/2"	2	Steel	H47900	→	→	→	→
0-910-0	Pipe Plug, 1"	5	Steel	AC1648	→	→	→	→
1-904-9	Screw, Housing/Casing	8	Steel	49511-304	→	→	→	→
3-018-3	End Cover, Inboard Coupling	1	Cast Iron	52-229-647-001	→	→	→	→
3-018-4	End Cover, Inboard Thrust	1	Cast Iron	52-229-646-001	→	→	→	→
3-025-2	Bearing Housing	2	Cast Iron	52-429-114-001	→	→	→	→
3-026-2	Ball Bearing, Radial	1	Steel	8050-31660	→	→	→	→
3-026-2	Ball Bearing, Thrust	1	Steel	52-119-728-001	→	→	→	→
3-078-9	Washer, Ball Bearing	1	Cast Iron	52-126-224-001	→	→	→	→
3-136-9	Deflector	2	Rubber/Steel	52-108-475-005	→	→	→	→
3-177-4	End Cap, Bearing Housing	1	Steel	52-260-478-003	→	→	→	→
3-177-9	Lip Seal, Outboard	2	Rubber/Steel	CP-753-383-034	→	→	→	→
3-177-9	Lip Seal, Inboard	2	Rubber/Steel	CP-753-383-034	→	→	→	→
3-409-9	Gasket, End Cover	2	Vellumoid	52-116-178-029	→	→	→	→
3-516-4	Locknut, Bearing	1	Steel	8601-3016	→	→	→	→
3-517-4	Lockwasher, Bearing	1	Steel	8910-0016	→	→	→	→
3-904-9	Screw, Housing/End Cover	4	Steel	49511-304	→	→	→	→
3-905-9	Grease Fitting, Straight Drive	2	Steel	9008-01610	→	→	→	→
3-915-9	Retaining Ring, Thrust	1	Steel	A06941A-315	→	→	→	→
-	O-Ring, End Cap	1	Buna-N	C02495A-239	→	→	→	→
<b>MECHANICAL SEAL</b>								
0-952-0	Flush Piping	1	Copper	52-127-293-504	→	→	→	→
1-909-9	Washer, Gland Screw	4/8*	316 Stn. Stl.	49519-60	→	→	→	→
3-014-2	Gland (CI Casing)	2	Cast Iron	52-235-277-003	→	→	→	→
3-014-2	Gland (DI Casing)	2	Cast Iron	52-327-658-004	→	→	→	→
3-400-0	Mechanical Seal, Std.	2	Viton/Carbon/Cer	52-240-979-001	→	→	→	→
3-400-0	Mechanical Seal, Balanced	2	Viton/Carbon/Cer	52-261-343-801	→	→	→	→
3-904-9	Screw, Gland	4/8*	316 Stn. Stl.	49511-306	→	→	→	→
3-914-2	O-ring, gland	2	Buna-N	C02495A-430	→	→	→	→
<b>PACKING</b>								
0-952-0	Flush Piping	1	Copper	52-127-293-502	→	→	→	→
1-013-2	Lantern Ring	2	Teflon	52-430-298-025	→	→	→	→
1-014-2	Gland (CI Casing)	2	Cast Iron	52-260-520-001	→	→	52-260-520-001+	→
1-014-2	Gland (DI Casing)	2	Cast Iron	52-235-608-002	→	→	52-235-608-001+	→
1-904-9	Screw, Gland	4/8*	316 Stn. Stl.	49511-309	→	→	→	→
1-909-9	Washer, Gland Screw	4/8*	Steel	49519-60	→	→	→	→
1-924-9	Packing Ring	10/12	Graphite Acrylic Yarn	AC6131	→	→	→	→

## Factory Recommended Spare Parts

\* Qty. 8 required for Ductile Iron Casing

\*\* 17 - 4 PH Condition H1150 is the standard shaft material for 8x12x27.

17 - 4 PH Condition H1150 is standard shaft material for sizes 12x16x23 and 14x16x17 when speeds are greater than 1200 RPM.

17 - 4 PH Condition H1150 is stainless steel shaft material option for sizes 10x14x20L, 12x16x23 and 14x16x17.

(1) Use with standard mechanical seal.

(2) Use with balanced seal

+ Bronze Material

ITEM NO.	PART DESCRIPTION	QTY.	MATERIAL	10x14x20L	12x16x23	14x16x17	14x18x23	14x18x28
2-001-0	Casing Assembly	1	Cast Iron	52-127-860-501	08-111-627-501	08-111-628-501	08-111-629-501	08-112-784-501
2-001-0	Casing Assembly	1	Ductile Iron	52-127-860-520	08-111-627-520	08-111-628-520	08-111-629-520	08-112-784-522
4-002-0	Impeller w/o Rings	1	Silicon Brass	52-161-304-001	08-217-814-002	08-217-815-002	52-222-594-002	08-217-817-002
4-002-0	Impeller w/ Rings	1	Silicon Brass	52-261-376-501	52-229-524-502	52-229-536-502	52-229-548-502	52-229-560-502
3-003-9	Casing Wear Ring	2	Bronze	52-127-508-001	08-111-673-001	08-111-673-001	08-111-674-001	08-111-674-001
0-004-0	Impeller Wear Ring	2	Bronze	52-127-847-001	52-120-561-001	52-120-562-001	52-120-563-001	52-120-564-001
2-123-6	Gasket, Discharge (CI Casing)	1	Vellumoid	08-217-568-005	08-217-570-005	08-217-572-005	08-217-574-005	08-217-576-005
2-123-6	Gasket, Discharge (DI Casing)	1	Vellumoid	52-237-035-005	52-430-162-005	52-327-405-005	52-235-101-005	52-327-896-005
2-123-5	Gasket, Suction (CI Casing)	1	Vellumoid	08-217-567-005	08-217-569-005	08-217-571-005	08-217-573-005	08-217-575-005
2-123-5	Gasket, Suction (DI Casing)	1	Vellumoid	52-237-034-005	52-430-161-005	52-327-404-005	52-235-100-005	52-327-895-005
3-007-0	Shaft	1	Steel	52-329-573-009	52-329-573-001**	→	52-329-574-001	→
3-007-0	Shaft	1	316 Stn. Stl.	52-329-573-004**	→	→	52-329-574-002	→
3-009-9	Shaft Sleeve (1)	2	Bronze	52-239-612-001	→	→	52-239-613-001	→
3-009-9	Shaft Sleeve (2)	2	Bronze	52-239-615-001	→	→	52-239-616-001	→
1-428-1	Gasket, Sleeve	2	Synthetic (Non-Asbestos)	70782-202B-5180	→	→	70782-203B-5180	→
3-015-9	Nut, Shaft Sleeve (1)	2	Bronze	52-128-684-001	→	→	52-128-682-001	→
3-015-9	Nut, Shaft Sleeve (2)	2	Bronze	52-128-684-001	→	→	52-128-717-001	→
3-902-9	Set Screw, Sleeve Nut	2	316 Stn. Stl.	49514-204	→	→	→	→
3-911-1	Impeller Key	1	316 Stn. Stl.	49568-328	→	→	52-119-854-015	→
3-911-2	Key, Coupling	1	Steel	49568-459	→	→	→	→
3-911-3	Key, Sleeve	2	316 Stn. Stl.	52-119-854-005	→	→	→	→
3-914-9	O-Ring, Shaft Sleeve	2	Buna-N	C024945A152-5302	→	→	C02495A-155	→
3-943-9	Anti-Rotation Pin	2	302 Stn. Stl.	CP-671-181-371	→	→	→	→
0-910-0	Pipe Plug, 1/4"	15	Steel	AC0532	→	→	→	→
0-910-0	Pipe Plug, 1/2"	2	Steel	H47900	→	→	→	→
0-910-0	Pipe Plug, 1"	5	Steel	AC1648	→	→	→	→
1-904-9	Screw, Housing/Casing	8	Steel	49511-304	→	→	→	→
3-018-3	End Cover, Inboard Coupling	1	Cast Iron	52-229-647-001	→	→	→	→
3-018-4	End Cover, Inboard Thrust	1	Cast Iron	52-229-646-001	→	→	→	→
3-025-2	Bearing Housing	2	Cast Iron	52-429-114-001	→	→	→	→
3-026-2	Ball Bearing, Radial	1	Steel	8050-31660	→	→	→	→
3-026-2	Ball Bearing, Thrust	1	Steel	52-119-728-001	→	→	→	→
3-078-9	Washer, Ball Bearing	1	Cast Iron	52-126-224-001	→	→	→	→
3-136-9	Deflector	2	Rubber/Steel	52-108-475-005	→	→	→	→
3-177-4	End Cap, Bearing Housing	1	Steel	52-260-478-003	→	→	→	→
3-177-9	Lip Seal, Outboard	2	Rubber/Steel	CP-753-383-034	→	→	→	→
3-177-9	Lip Seal, Inboard	2	Rubber/Steel	CP-753-383-034	→	→	→	→
3-409-9	Gasket, End Cover	2	Vellumoid	52-116-178-029	→	→	→	→
3-516-4	Locknut, Bearing	1	Steel	8601-3016	→	→	→	→
3-517-4	Lockwasher, Bearing	1	Steel	8910-0016	→	→	→	→
3-904-9	Screw, Housing/End Cover	4	Steel	49511-304	→	→	→	→
3-905-9	Grease Fitting, Straight Drive	2	Steel	9008-01610	→	→	→	→
3-915-9	Retaining Ring, Thrust	1	Steel	A06941A-315	→	→	→	→
-	O-Ring, End Cap	1	Buna-N	C02495A-239	→	→	→	→
<b>MECHANICAL SEAL</b>								
0-952-0	Flush Piping	1	Copper	52-127-293-504	→	→	→	→
1-909-9	Washer, Gland Screw	4/8*	316 Stn. Stl.	49519-60	→	→	→	→
3-014-2	Gland (CI Casing)	2	Cast Iron	52-235-277-003	→	→	52-235-280-001	→
3-014-2	Gland (DI Casing)	2	Cast Iron	52-327-658-004	→	→	52-329-767-003	→
3-400-0	Mechanical Seal, Std.	2	Viton/Carbon/Cer	52-240-979-001	→	→	52-240-946-801	→
3-400-0	Mechanical Seal, Balanced	2	Viton/Carbon/Cer	52-261-343-801	→	→	52-261-285-801	→
3-904-9	Screw, Gland	4/8*	316 Stn. Stl.	49511-306	→	→	→	→
3-914-2	O-ring, gland	2	Buna-N	C02495A-430	→	→	C02495A-436	→
<b>PACKING</b>								
0-952-0	Flush Piping	1	Copper	52-127-293-502	→	→	→	→
1-013-2	Lantern Ring	2	Teflon	52-430-298-025	→	→	52-430-298-026	→
1-014-2	Gland (CI Casing)	2	Cast Iron	52-260-520-001+	→	→	08-217-583-501	→
1-014-2	Gland (DI Casing)	2	Cast Iron	52-235-608-001+	→	→	52-235-606-002	→
1-904-9	Screw, Gland	4/8*	316 Stn. Stl.	49511-309	→	→	→	→
1-909-9	Washer, Gland Screw	4/8*	Steel	49519-60	→	→	→	→
1-924-9	Packing Ring	10/1 2	Graphite Acrylic Yarn	AC6131	→	→	CF	CF

## Factory Recommended Spare Parts

\* Qty. 8 required for Ductile Iron Casing

\*\* 17 - 4 PH Condition H1150 is the standard shaft material for 8x12x27.

17 - 4 PH Condition H1150 is standard shaft material for sizes 12x16x23 and 14x16x17 when speeds are greater than 1200 RPM.

17 - 4 PH Condition H1150 is stainless steel shaft material option for sizes 10x14x20L, 12x16x23 and 14x16x17.

(1) Use with standard mechanical seal.

(2) Use with balanced seal

+ Bronze Material

CF Consult Factory

# Xylem |'zīləm|

- 1) The tissue in plants that brings water upward from the roots;
- 2) a leading global water technology company.

We're a global team unified in a common purpose: creating advanced technology solutions to the world's water challenges. Developing new technologies that will improve the way water is used, conserved, and re-used in the future is central to our work. Our products and services move, treat, analyze, monitor and return water to the environment, in public utility, industrial, residential and commercial building services settings. Xylem also provides a leading portfolio of smart metering, network technologies and advanced analytics solutions for water, electric and gas utilities. In more than 150 countries, we have strong, long-standing relationships with customers who know us for our powerful combination of leading product brands and applications expertise with a strong focus on developing comprehensive, sustainable solutions.

**For more information on how Xylem can help you, go to [www.xylem.com](http://www.xylem.com)**

We value your feedback. Please take our 3 question survey at **[bellgossett.com/survey](http://bellgossett.com/survey)** to let us know how we are doing.



Xylem Inc.  
8200 N. Austin Avenue  
Morton Grove, Illinois 60053  
Phone: (847) 966-3700  
Fax: (847) 965-8379  
[www.xylem.com/bellgossett](http://www.xylem.com/bellgossett)

Bell & Gossett is a trademark of Xylem Inc. or one of its subsidiaries.  
© 2020 Xylem Inc. CP-506D-PL April 2020